



# Starting School in Reception at Warren Road Primary School



[www.warrenroadprimary.co.uk](http://www.warrenroadprimary.co.uk)

## Welcome

Welcome to Warren Road Primary School. Your child's welfare and well-being are of paramount importance to us. We operate an open-door policy so, if you have any questions or concerns about your child, please do not hesitate to contact us. We are here to help and support you and your child as they transition into their full time education and we hope that they will have a very happy time at Warren Road.

Various school policies are available on the school website:  
[warrenroadprimary.co.uk/school-policies](http://warrenroadprimary.co.uk/school-policies)

## Our Aims for your child:

- Be happy and feel positively about school
- Feel safe and secure in their new environment
- Make friends with peers
- Develop confidence in relating to and cooperating with new adults and children
- Be polite, kind and considerate towards others
- Become more independent and resilient when tackling new skills and activities
- Develop good attention skills and the ability to concentrate on tasks
- Develop their vocabulary and communication skills, being able to express their opinions and know that their ideas will be valued
- Achieve their best in all areas of the curriculum and feel proud of their achievements

## Warren Road School Values

Our values thread through everything we do at Warren Road. They are there to teach and support the children to be amazing learners and superb citizens within our school.

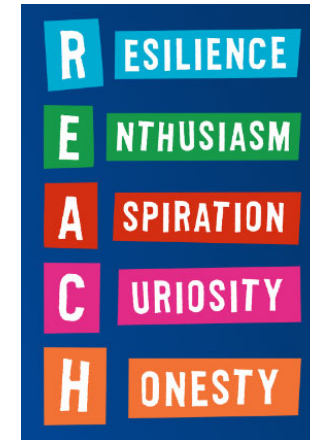

Children start school in the September of the academic year when they turn 5 years old. At Warren Road, the children will be grouped equally across four Reception classes. The following plan shows where these classes are situated in the Reception building:

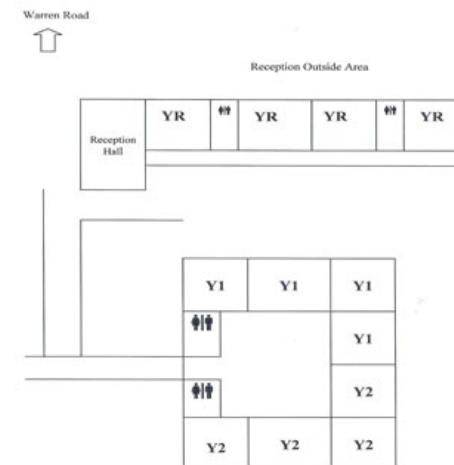

## The Reception Curriculum

The Early Years Foundation Stage Framework (EYFS) consists of three prime areas and four specific areas of learning and development. The prime areas cover the knowledge and skills which are the foundations for children's development and future progress. These skills are applied and reinforced by the specific areas, which form an appropriate starting point for the Year 1 curriculum.

The Reception curriculum consists of;

### The Prime Areas

Personal, Social and Emotional Development  
Physical Development  
Communication and Language

### The Specific Areas

Literacy  
Mathematics  
Understanding the World  
Expressive Arts and Design



Further information regarding this can be viewed in the Early Years Foundation Stage Handbook 2024.

## Methods of Teaching and Learning

*“Children learn and make progress through play, by adults modelling, by observing and following each others’ lead and through guided learning and direct teaching.”*

**Development Matters, 2022**

Our staff will carefully organise their environments to enable high-quality play. At times, they will make time and space available for children to invent their own play, or they join in to sensitively support and extend children's ideas.

The children in Reception will also learn through group work, with adults guiding their learning. Learning could take place inside the classroom, or in the outdoor area, which will also be planned carefully to develop and challenge the children appropriately.

When planning for learning opportunities, the Reception team will aim to:

- Interest and motivate the children;
- Develop their feelings of security and confidence;
- Extend their vocabulary and language skills;
- Develop their fine and gross motor skills;
- Develop their concentration and persistence;
- Encourage their personal interaction with their peers so that they quickly form friendships and settle into their new environment;
- Follow and build on the interests that are expressed throughout the year.

## Our Transition Programme

To support the children to adjust to the Reception environment, we have planned a gradual introduction to school:

### Stay and play sessions—Tuesday 9th and Tuesday 16th July

Come to the classrooms for two 45 minute sessions, where your child will get to know their new environments and form relationships with the adults that will be teaching them in September.

Parents are asked to attend two presentations from staff at the same time, which will support the parental transition into your child starting school.

## **Summer PTA Playdate—Tuesday 20th August**

The PTA will be hosting a playdate in the Reception outdoor area and hall. This will encourage children to form and build relationships with each other and have another opportunity to experience the learning environment, as well as give parents the opportunity to get to know others within the cohort.

## **Starting School**

In September our School Induction Programme will be phased in order to accommodate and settle the large number of children starting in September.

### **Week 1—Parent and child meetings: Tuesday 3rd and Wednesday 4th September**

During the first two days of term we will be holding short Parent and Child Meetings at school. You will need to sign up for an appointment time for you and your child to come into school to chat to your child's class teacher.

### **1st Day at school—Thursday 5th September**

From 9.00am to 1.00 pm (including lunch) - Please bring your child into the Reception Playground where you will be greeted by staff. The first morning will be a soft start with plenty of time to take photos and celebrate your child's start to school. Once you have said goodbye, your child will go into school via their classroom door. Parents return at 1.00pm to collect your child from the same classroom door. Remember to bring your child's lunch bag if they are having a packed lunch!

### **Friday 6th September**

9.00am to 1.00pm (including lunch) – When your child's teacher opens the classroom's external door at 9am on the Reception playground, your child should say goodbye and go straight in with the teacher. Please return at 1.00pm to collect him/her from the classroom, via the same door.



### **Week 2—from Monday 9th September onwards**

From 9.00 am to 3.20 pm - From now on your child will attend school for the full day. Please be prompt in collecting your child. If you should happen to be late in collecting your child, he/she will be taken to the main office and remain there until you arrive. A quick phone call to the office helps us to reassure your child that you are on your way.

You are very welcome to talk to the teacher about your child at the end of a school day. If you require a longer, more formal or private meeting, please make an appointment at a mutually agreed time. Please note that on Tuesdays and Thursdays there are staff meetings starting at 3:45pm so teachers' time on these days is limited. Teachers will not be able to meet with parents in the morning as the school day starts promptly when the children arrive.

### **Settling in to school**

Starting school is an enormous step for a child to take and some children will have no problem adapting to school life, whilst others will need lots of reassurance.

Should your child cry, try to stay calm even though you are feeling as upset as he/she is. Make a firm exit, leave with a wave and a smile. Teachers and Teaching Assistants are used to dealing with children in this situation and will be able to calm and comfort your child after you leave. Be reassured that we will contact you if your child does not settle quickly.

There are times in your child's school life where he/she may feel worried or anxious because of circumstances outside of the control of school; it may be the arrival of a new baby or a house move. If you could let us know of these circumstances, it would help us to be aware and sympathetic to your child's difficulties. We wish to help your child in every way possible.

### Attendance and Punctuality

If your child is ill, or absent for any other reason, please inform the school office as early as possible on a daily basis. If your child has sickness or diarrhoea, they will need to be absent from school for at least 48 hours after the last bout of illness to ensure they are not contagious.

If your child has a medical appointment you will need to notify the school office in advance and let them know when you will collect your child. *Please also message your child's teacher via Class Dojo so that they know what time to get your child ready for their appointment.*

It is very important that the school office has at least 3 emergency contact numbers in case your child is unwell whilst they are at school. Please ensure that you contact the office to update them if there are changes.

The school is unable to authorise absence for holidays, except under exceptional circumstances agreed by the Headteacher.

*Punctuality and attendance are extremely important for both your child's educational and social wellbeing.*

	Morning Registration	End of Day
Reception	9am	3:20pm
Key Stage 1 (Years 1 and 2)	8:45am (children can come into class from 8:45—8:55)	3:20pm
Key Stage 2 (Years 3—6)	8:45am (children can come into class from 8:45—8:55)	3:30pm

### Travel to School

As an Eco School we promote sustainable ways of travelling to and from school. Children are encouraged to walk to school as often as possible.

Scooter racks and a bike shed are also provided but children should not scoot or cycle once they are inside the school gates. If you bring your child to school by car, you may wish to 'park and stride', i.e.

park 10 minutes' walk away from the school. When parking near the school gates, please be considerate towards our neighbours and help ensure the safety of our children by not parking on zig zag lines.



### Lunch Arrangements

You child will eat in the hall with the other Reception children and a midday meal supervisor will be with them all the time.

The lunch break for Reception pupils is from 11.50am to 1.00 pm. Your child has the choice of:

**Eating a school dinner** – Every child starting school in Reception will be entitled to have a free school meal. Further information will be provided in September regarding this. Independent Caterers will supply a menu which will be emailed to you so that you can discuss the choices with your child each morning.

**Bringing a packed lunch** – This can be in a named box/bag with an ice pack enclosed in hot weather. We are a NUT and SESAME SEED FREE school (including nut based chocolate spread). Please do not include ANY nut or sesame products in your child's packed lunch as several children in school suffer from severe nut allergies.

We are a 'Healthy School' and encourage all children to eat well. Please ensure no chocolate, sweets or fizzy drinks are put in lunch-boxes.

## Playtimes

**Drinks** – your child must bring water in a named refillable flask or plastic bottle to have throughout the day. We have drinking water taps in the classrooms when refills are required.

**Snacks** – your child will be offered a piece of fruit to eat during the morning, as part of the government's scheme providing free fruit to infant age pupils.

**Accidents** – if your child has a fall resulting in a minor cut, bump or graze he/she will be cleaned up by a member of staff and kept in school. Teachers will inform you of any bumps to the head because of the possibility of delayed concussion. Children wear stickers to inform others of their head injury.

You will be notified of any serious injuries by telephone so that your child can be collected and given any necessary medical treatment. Please ensure that we have up to date emergency telephone numbers for contacting you in the event of your child being ill or having an accident.

## Things your child will need

**Uniform** – (see list in starter pack and on school website) This can be purchased from Graduates School Shop in Orpington High Street or from our PTA Nearly New Uniform shed.

**Waterproof coat each day**

**Book Bag**

**Wellington boots** (these will stay in school) **Water Bottle**

### PE Kit

November - Easter (indoor gymnastics and dance)

House colour t-shirt (to be given to you by your class teacher when they join in September)  
Blue PE shorts

Summer Term (outdoor ball skills and athletics)

House colour t-shirt  
Blue PE Shorts  
Blue/black tracksuit top  
Blue/black tracksuit bottoms (optional)  
Trainers

Please do not purchase a PE kit until your teacher has informed you of the house colour your child is in. Children will not need a PE kit in school until after the October half term.

Please ensure all items are clearly labelled with your child's name. Please practise doing up shoes, buttons and zips with your child at home so that they can become independent at dressing/undressing in school. Velcro fastenings on shoes aid independence.

**Jewellery** - The wearing of jewellery is not permitted, with the exception of ear studs. It can be dangerous, particularly in PE lessons, both to the wearer and other children. If ear studs are worn they must be removed before coming to school or taped over for PE lessons. Please provide tape for the class teacher to do this.

**Toileting** – Your child should be able to manage to go to the toilet without help. If a child has an accident in school, they are given spare clothes to change into. We appreciate it if these clothes are washed and returned to school within the following few days.

## Communication

Our primary forms of communication with parents are via email from the school office. We also use Class Dojo for more informal messages and opportunities to share day to day activities that your child is taking part in. Further information will be sent out in the Autumn Term.

## Home Learning

Your child's learning and progress is achieved most effectively when supported at home as well as in school. Your child will have the opportunity to engage in homework tasks over each term. Reading books will be sent home each week. You will receive a reading record book for teacher and parental comments.

**Reading together**— It is important that you read books together in a quiet and relaxed atmosphere and that you choose a time that is suitable for you both. Make sure that you are both sitting comfortably and try not to have any distractions and if your child is tired or loses interest then it is better to stop and choose another time.

### Early reading tips

- Make sure that your child can see the words and pictures.
- Look at the pictures and talk about what you both notice.
- Always allow plenty of time to talk about the story and ask questions, such as 'What do you think will happen next?'
- If your child is reading to you and they are stuck on a word, encourage them to guess the word from the context of the story, the picture or from the first letter. If this fails, tell them the word.
- Always give plenty of praise and make reading together an enjoyable time.

Remember, even when your child can read fluently, it is important that you continue to share stories together.

Throughout the year, we will send home lists of words which should be practised on a regular basis at home.

We love to receive updates about your child's achievements at home. We will inform you how to do this once your child has settled into school.

### Celebration Assembly

Each week we hold a Reception 'Celebration Assembly' when we celebrate specific achievements that have occurred that week. This is often linked to the REACH values that children are demonstrating in school.

### Children with Special Education Needs

We see every child as special with differing needs and some children might need to be given more support than others. If we feel that your child would benefit from a special programme of support, we will contact you before embarking on the programme. Children may of course have been identified as having needs in their pre

school, for example speech and language therapy, and we will discuss opportunities for this with you as your child starts school. If you have any information regarding support your child has already received please let Mrs Read (SENCO) know as soon as possible.

[send@warrenroad.bromley.sch.uk](mailto:send@warrenroad.bromley.sch.uk)

### Warren Road PTA

The Parent Teacher Association (PTA) raise funds through popular events for facilities and equipment that would not otherwise be provided e.g. wet play toys, sports kit. As a parent or carer of a child at Warren



Road, you are automatically a member of the PTA and they are always looking for new committee members and volunteers to help at events. New ideas and skills to help raise funds are particularly welcome!

### Parental Help

Once your child is settled into school we welcome parental help. Any parent wishing to assist must successfully complete an enhanced Disclosure and Barring Service (DBS) check. Please speak to your child's class teacher about this possibility.

**We will do our best to ensure that your child has a happy and positive start to school life. If they appear to be unhappy about anything to do with school, please discuss this with the class teacher, or with another relevant member of staff, so that problems can be sorted out quickly.**

*We look forward to your child joining us at  
Warren Road Primary School.*